

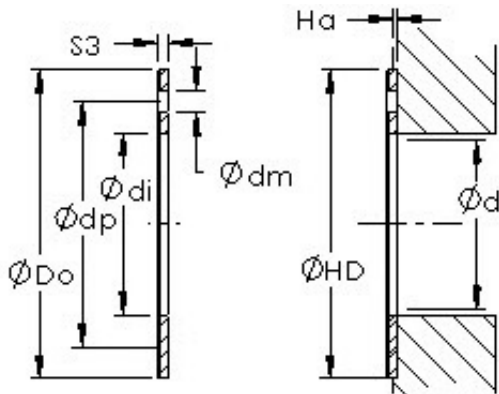

# FML sKE Manufacturing Co., Ltd



## AST AST50 WC14IB plain bearings

Bearing No. AST50 WC14IB

Bore Diameter	22,225 mm
Bearing Type	thrust washer
Shaft Dia., Nominal (d)	0.8750
Bearing Outside Dia., Nominal (D)	1.7500
Washer Inside Diameter, Nominal (di)	1
Washer Inside Diameter Tolerance (di tol.) - +.010 / -0	
Washer Outside Diameter, Nominal (Do)	2
Washer Outside Diameter Tolerance (Do tol.) - +0 / -.010	
Washer Thickness, Nominal (S3)	0
Washer Thickness Tolerance (S3 tol.) - +.001 / -.001	
Mounting Hole Dia. (dm)	0.130
Mounting Hole Pitch Dia. (dp)	1.38
Housing Counterbore Depth (Ha)	0.04
Housing Counterbore Depth Tolerance (Ha tol.) - +.010 / -.010	
Housing Counterbore Diameter, Nominal (HD)	1.750
Housing Counterbore	+0.010 / 0

AST50 WC14IB Bearing 2D drawings and 3D CAD models



## FML ske Manufacturing Co., Ltd

Diameter Tolerance (HD tol.) - $+0.010 / -0$	
Material	Carbon steel shell with PTFE / Fiber lining